

NOTES:

(N1) 1. FIT / FORM / FUNCTION SHALL FOLLOW PS-E.008.

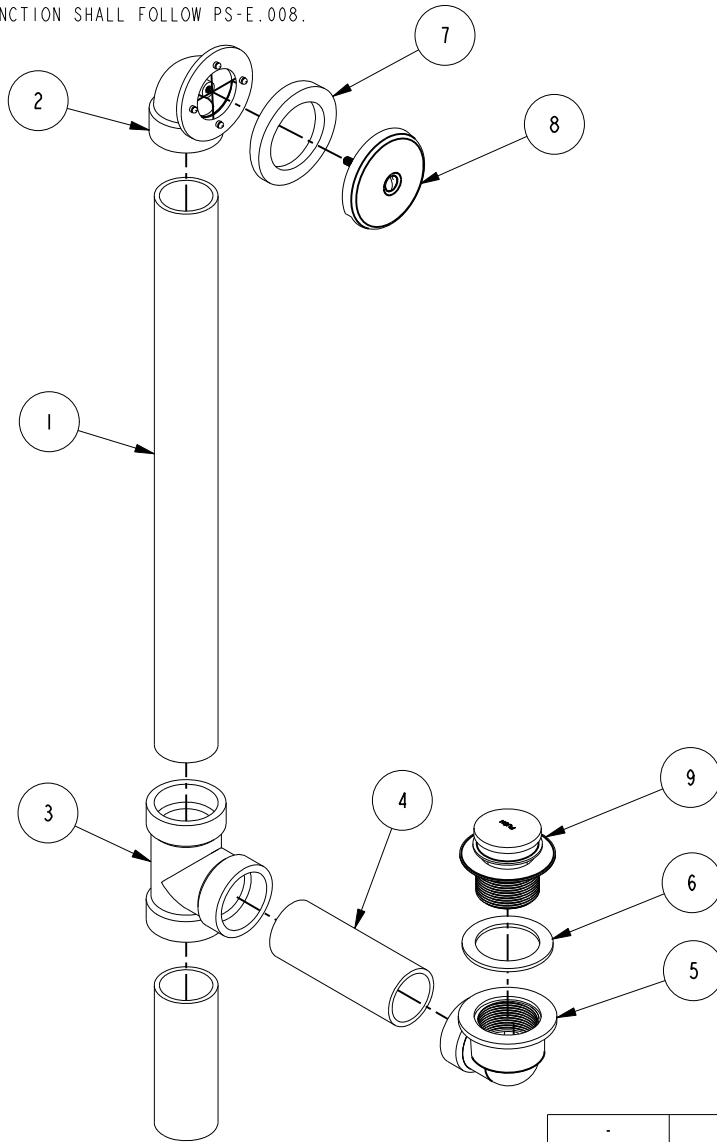

BILL OF MATERIAL (CURRENT LEVEL)

| ITEM | PT/ASSY | DESCRIPTION | TYPE | QTY. |
|------|---------|--------------------------|----------|------|
| 1 | 50253 | 20" ABS PIPE | PART | 1 |
| 2 | 50255 | ELBOW OVERFLOW 1-1/2 IN. | PART | 1 |
| 3 | 50257A | TEE 1-1/2" ABS (4C-B) | PART | 1 |
| 4 | 50254 | 5" ABS PIPE | PART | 2 |
| 5 | 50256 | ELBOW WASTE 1-1/2 IN. | PART | 1 |
| 6 | 91170 | WASHER | PART | 1 |
| 7 | 91171 | GASKET | PART | 1 |
| 8 | 265 | FACEPLATE FOR W/O | ASSEMBLY | 1 |
| 9 | 272 | TOE ACTIVATED TUB DR | ASSEMBLY | 1 |

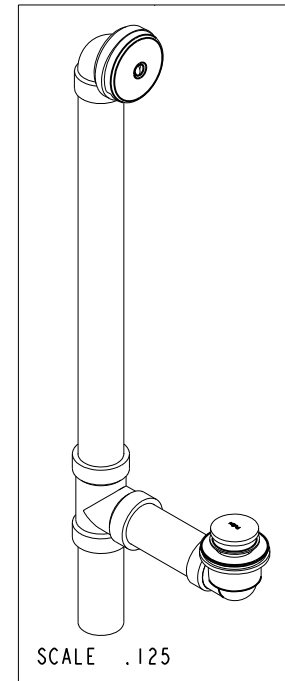

UNITS ARE: INCHES [MM]
TOLERANCES ARE:
FRACTIONS DECIMALS ANGLES
±1/16" .X ±.1 [2.5] ±1°
.XX ±.06 [1.5]

(X.XXX) DENOTES CRITICAL DIMS.
ALL THREADS ARE CRITICAL

DRAWN C. GAYOSSO 12/20/17
CHECKED V. VU 12/20/17
APPROVED V. VU 12/20/17

BRASSTECH 2001 CARNEGIE AVE.
INCORPORATED SANTA ANA, CA 92705
(949) 417-5207

TOE ACTIVATED W/O

DWG NO. 255
SCALE .175 REF. - SHEET | OF |

COPYRIGHT 2005 BRASSTECH, INC.
THESE DRAWINGS AND THE DESIGNS
DEPICTED HEREIN ARE THE PROPRIETARY
PROPERTY OF BRASSTECH. ANY USE
OR REPRODUCTION IS SUBJECT TO
THE EXPRESS APPROVAL OF BRASSTECH.
UNAUTHORIZED USE IS STRICTLY
PROHIBITED. ALL RIGHTS RESERVED.

| TESTING | ASSEMBLY | PLATING | POLISHING | MACHINING | TOOLING FIXTURE # | APPLICATION |
|---------|----------|---------|-----------|-----------|-------------------|----------------------------------|
| - | - | - | - | - | | REMOVE ALL BURRS AND SHARP EDGES |
| | | | | | | USED ON |

| ZONE | REV | DESCRIPTION | DATE | APPROVED |
|------|-----|-------------|----------|----------|
| - | - | EN-3504 | 12/20/17 | V.V. |