

Soho Mixer Two-Way

by JEE-O



 ADA compliant

 RAW (brushed)
700-2200

 hammercoat black
700-2202

 custom finish
700-220C

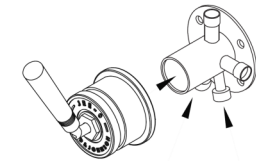

inlet hot inlet cold

SPECIFICATIONS

MATERIAL:	304 stainless steel
FEATURES:	two-way pressure balance valve
CARTRIDGE:	progressive two-way mixing mechanism (#005-0203)
WEIGHT:	7 lbs
PACKAGE DIMENSIONS:	L 12" x W 8" x H 6"
DELIVERY WEIGHT:	8 lbs
WARRANTY:	2-year limited warranty

MAINTENANCE & CARE

RAW (BRUSHED):	Regularly apply stainless steel cleaner and rub in the direction of the grain, using a slightly abrasive sponge.
HAMMERCOCOAT BLACK:	Regularly clean with soap water or alcohol. Do not use abrasives.

