

# Installation Instructions

## for Deck Mounted Pull Down/Pull Out Single Handle Faucets



The 111-7.1.3PG2-SP4V will be used as an example in this manual.  
Applicable for all 7.1.3P1, 7.1.3PG2, 9.1.3P1, and 9.1.3PG2 models.

## IMPORTANT INFORMATION

Thank you for choosing Watermark! We appreciate your commitment to Watermark quality products. Before you install the product, please fully review these installation instructions.

Before installation, unpack the product and inspect it for any damage. Make sure all the parts are present. If not installing immediately, place the product back into its protective packaging.

The appearance of the product may be different than what is shown in this installation manual, but the installation procedure will be the same.

Installation considerations:

- Professional installation by a licensed plumber is strongly recommended.
- Product should be installed according to local codes and regulations.
- When installing:
  - Use Teflon tape or pipe sealant for threaded connections.
  - DO NOT use plumber's putty on any brass components. This may cause the finish to tarnish and void the warranty. Alkoxy silicone is recommended instead.
  - Flush the lines before and after installation (if applicable).
  - If the lines are sweated, do not overheat casting, which may damage mechanisms.
- Copper adaptors may be required to complete installation.

If you encounter any issues, please contact our technical support team at the number listed at the bottom of this page or email us at: [technical@watermark-designs.com](mailto:technical@watermark-designs.com)

## PARTS BREAKDOWN

### Handle Assembly

### Spout Assembly

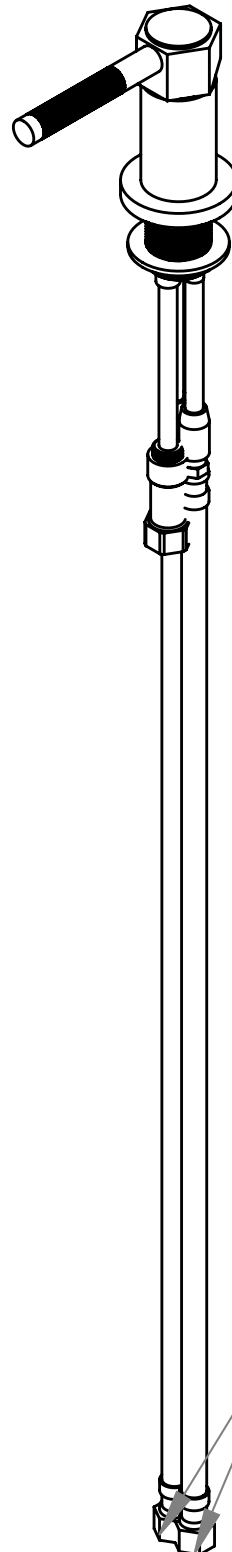
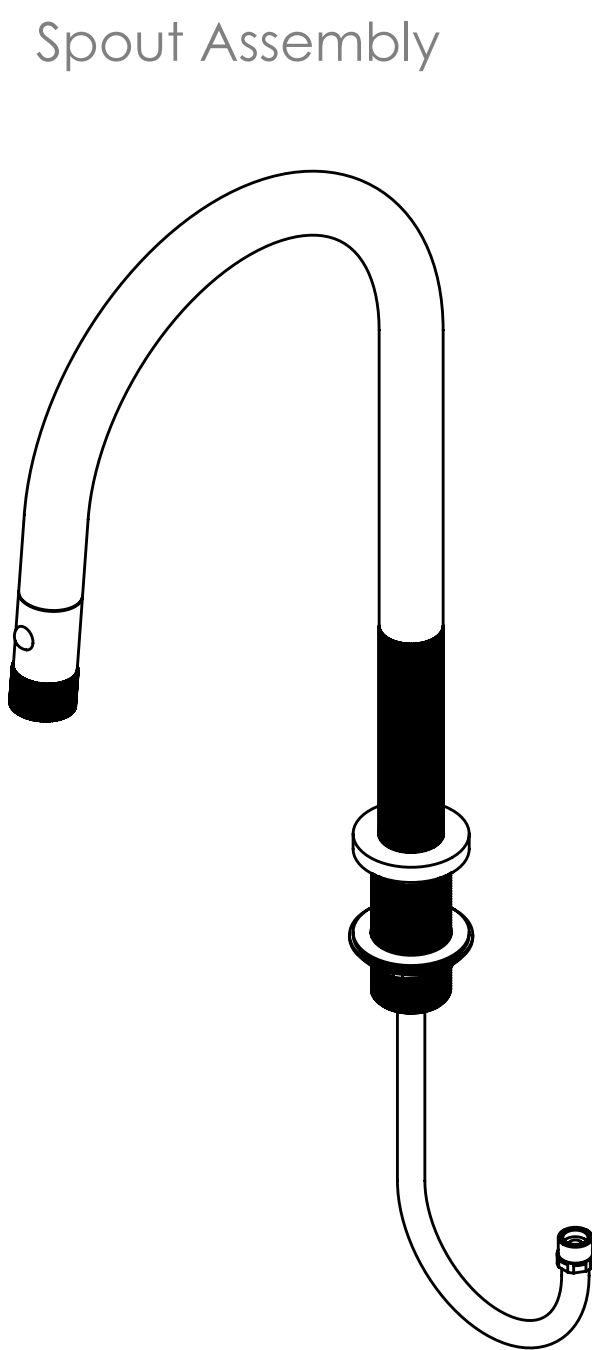

### Hose Weight

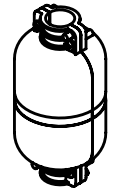

2x 3/8"  
COMPRESSION  
FEMALE

### You will need:

- 1 x Wrench
- 1 x Screwdriver

## 1. Prepare the mounting surface

Make 2 holes in the mounting surface following the requirements shown on the drawing.

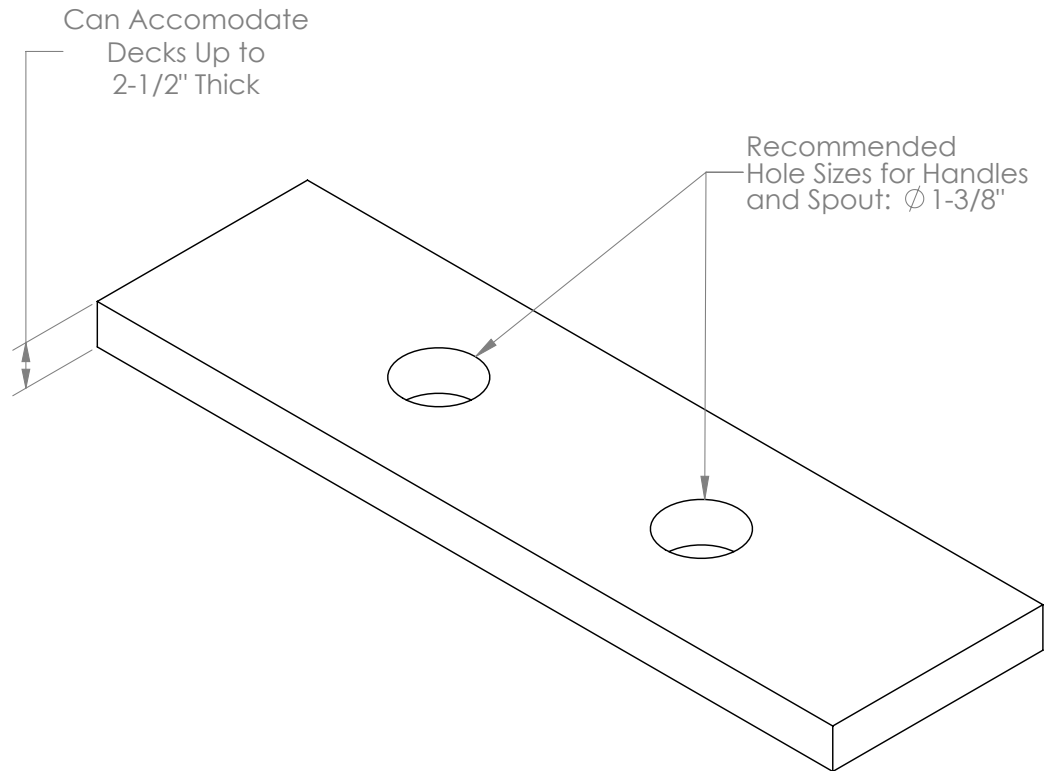

## 2. Install the spout

Insert the spout assembly through the hole in the mounting deck. Insert the rubber gasket, metal washer, and lock nut onto the bottom of the spout nipple.

Tighten the lock nut to secure the spout onto the mounting surface

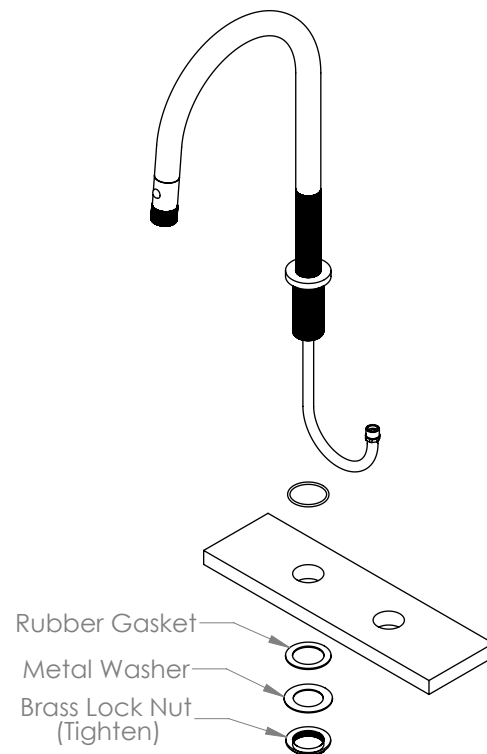

**NOTE: Hose length shown is not to scale**

## 3. Install the handle and connect the spray hose

**[A]** Insert the handle assembly into the hole on the mounting surface. Thread the lock nut onto the bottom of the handle, beneath the mounting surface.

**[B]** Align the handle. The pull down spray supply riser, which is shorter than the two other supply risers, should be pointing towards the user.

**[C]** Tighten the lock nut against the bottom of the mounting surface to secure the handle.

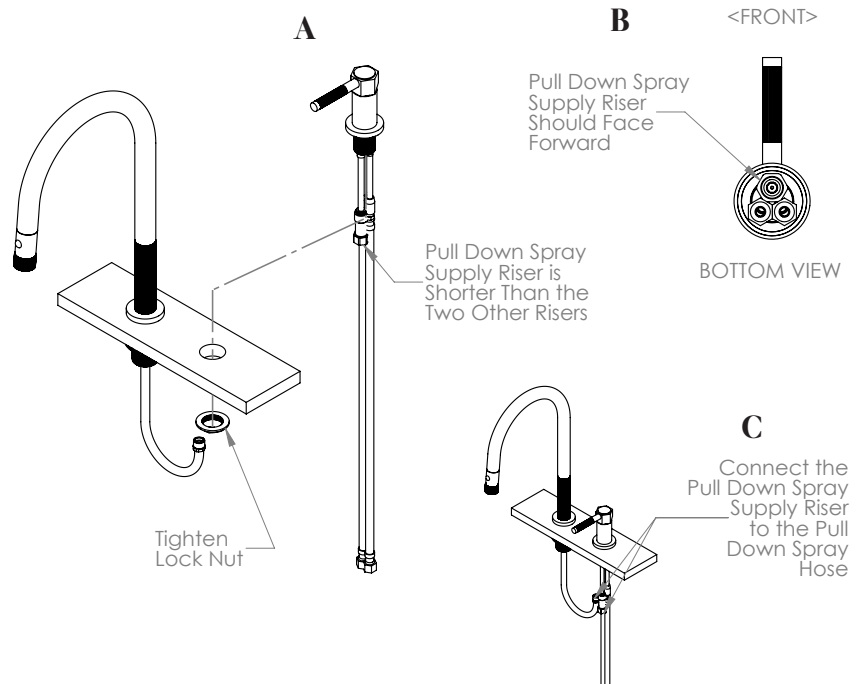

## 4. Install the hose weight and connect the hoses

**[A]** Attach the hose weight on the side of the hose loop that goes into the spout. Adjust the location based on how much you need the pull-down spray to extend.

**[B]** Connect the two flex hoses to the supply stop (sold separately).

